

## INSTALLATION AND SETUP GUIDE

### GENERAL INFORMATION

The Code Encryptor 3 (CE3) provides wireless control for arming/disarming a security system, opening/closing a garage door, and activating a relay output (ex. turning on a light). The CE3 consists of a Receiver and wiring harness, remote control keyfob, and a status LED with optional mounting plate.

The most important factor for range and reliability is the mounting location of the Receiver. Select a location that is as centrally located as possible. Keep in mind that the user will want to control the operation of the garage door from the driveway, and will also expect the use of the remote for alarm on/off in the area of entry and exit.

Although you can wire the Receiver to the panel, it may reduce labor by installing the CE3 Receiver at the point of entry and wire it to a nearby keypad. In most cases this is the garage entry, which will provide an easy installation for garage door open/close, status indicator, and alarm controls through the keypad.

**IMPORTANT:** Do not mount the Receiver module inside the alarm panel enclosure; it will reduce the reception of the remote keyfob.

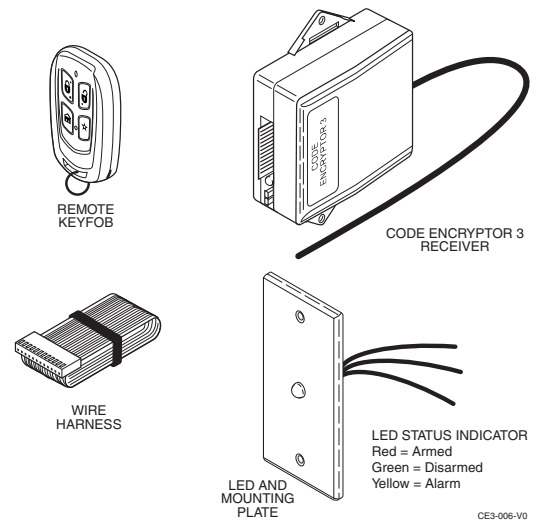

### Installation Steps

1. Connect the CE3 Receiver to the control panel.
2. Program the CE3:
  - a. Associate the Receiver with the connected control using Automatic Recognition.
  - b. Program a user code for the Remote Keyfob.
3. Wire optional features, if used (Status LED, Garage Door Opener, Relay Outputs).
4. Test the System.

### CONNECTING THE RECEIVER TO THE CONTROL PANEL

The Receiver can be wired either to the control's terminals or to a keypad's terminals.

1. Unplug the Receiver from the wire harness.
2. Connect the Red, Black, Yellow and Green wires to the keypad or control's terminals as shown in the diagram.

**NOTE:** You can make these connections at the control or at the keypad itself. If you place the Code Encryptor 3 in the garage or any other location away from the control, you may choose to wire the Code Encryptor 3 directly to the keypad.

#### Summary of Basic Connections

Wire Color	Connection
Red	Keypad Red or Aux (+)
Black	Keypad Black or Aux (-)
Green	Keypad Green (control Data In)†
Yellow	Keypad Yellow (control Data Out)

† not used on GE Caddx NX panels

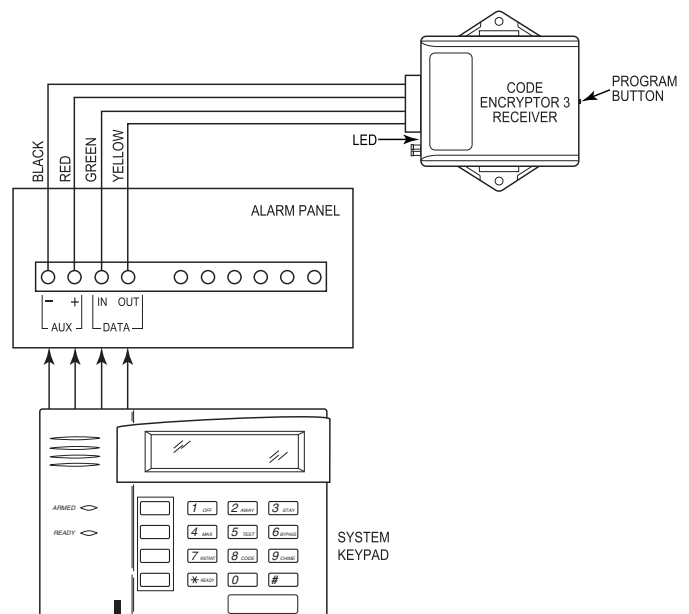

## PROGRAMMING THE CODE ENCRYPTOR 3

Programming involves first associating the module with the control with which it is being used (auto recognition), and then programming the remote control's user code.

### Automatic Recognition

1. Make sure the alarm panel is powered up and operating. The wire harness should still be disconnected from the Receiver.
2. While watching the LED light on the CE3 Receiver, plug the wire harness connector into the Receiver.
3. The Receiver's LED will blink one time on power up. After about 2 seconds, count the flashes that you see. The corresponding flashes indicate which panel the Code Encryptor 3 has detected. Refer to the table below.

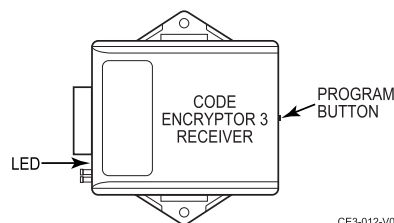

### Control Panel Detection Table

No. of Flashes	Alarm Panel detected by the CE 3
1	No Alarm connected (CE3 defaults to relay mode) See "Default Mode"
2	Future use
3	**GE/NX4, NX6, NX8, NX8V2
4	Future use
5	Honeywell - Non-Addressable (Vista & 4110, XM, XMP)
6	Honeywell - VISTA Addressable (Vista-10P, 12D, 15P, 20P, 21iP, 48LA)
7	DSC- PowerSeries 816/832/5010/5020, PC1616/1832
8	DSC PC1550, 2525, 2550, 3000
9	**Napco P816/1632/3200
10	Future use

\*\* For these panels, open top cover and slide switch away from LED

The Code Encryptor 3 on the following panels self-enroll themselves as a specific keypad address code.

Control	Address
Honeywell addressable	3 (VISTA-50)
Honeywell addressable (P controls)	17

**IMPORTANT: DO NOT USE ANY OF THESE ADDRESS CODES IF YOU ARE USING ONE OF THE ABOVE CONTROLS.**

Example: If you are using a Honeywell Vista P series control, no keypads can use address 17 because the CE 3 will automatically enroll itself as address 17.

**NOTE:** If you are using the Honeywell Touchscreens, please remove them when Programming the Code Encryptor 3.

### Programming the User Code

A user code for the Code Encryptor 3 must be programmed in the security system and in the CE3 Receiver. This provides the system with a user code for arming and disarming of the control.

To program a user code into the Receiver, do the following:

1. Verify that the four-digit code you plan to teach the Code Encryptor 3 is a valid four-digit user code. Example: From the keypad use that four-digit code to arm the panel. If the panel arms, the code is good. If it does not, program that user code into the alarm panel. – The Code Encryptor 3 uses that four-digit code to arm and disarm the panel, thus that code must be valid.

**NOTE:** We recommend using a user code that the user cannot change. If the user code that is programmed into the Receiver module is changed, the Code Encryptor 3 will not disarm the control panel.

2. Press and HOLD the program button on the Receiver. The LED will light. Continue to hold program button until the LED turns OFF (in about 7 seconds). When the LED turns off, release the program button. The LED will begin to flash rapidly.
3. Using the keypad, slowly and firmly enter the four-digit user code (no other commands). After the fourth entry the LED will stop flashing. This code has now been entered into the Code Encryptor's non-volatile memory. The Code Encryptor will remember this user code in the event of a power failure. To change to a new user code, repeat steps 2 and 3 above.

### Adding/Deleting Remotes

#### To Add a New Remote

To add a remote to your Code Encryptor 3, do the following:

1. PRESS AND RELEASE the program button on the receiver. The LED on the receiver will come ON.
2. Immediately PRESS button 1 on the new remote control THREE TIMES. The LED on the receiver should go OFF indicating the remote has been learned.

If the LED on the receiver stays ON, the remote has not been learned. Remove and replace the harness, wait 15 seconds while auto recognition occurs and follow these instructions again.

#### To Delete All Remotes

To delete a lost or stolen remote from the Code Encryptor 3, you must purge the entire memory. This will delete all of the current remotes. You will then have to add them back into memory.

To purge, PRESS AND HOLD the program button. The LED will come ON for four seconds, then go OFF, and finally it will come ON again, indicating that all the remotes in memory have been purged. Release the program button and follow the To Add a New Remote instructions.

# WIRING FOR OPTIONAL FEATURES AND APPLICATIONS

## Summary of Harness Wire Functions

Purpose	Wire Color	Function
Keypad Connections	Red	Keypad Red or Aux (+12VDC)
	Black	Keypad Black or Aux (-)
	Green	Keypad Green (control Data In); Not Used on GE Caddx NX panels
	Yellow	Keypad Yellow (control Data Out)
LED Status	Purple	LED Status Light Purple wire (Green light)
	White/Purple	LED Status Light white/purple (Red light)
Relay Output Button	Blue/Green	Channel 4 N/C (5amp)
	Brown/White	Channel 4 N/O (5amp)
	Brown	Channel 4 Common (5amp)
Garage Door Opener	White	Channel 3 Common (Garage Door Pushbutton)
	Red/White	Channel 3 N/O relay (Garage Door Pushbutton)
Entry/Exit zone	Gray	Channel 1 (-) momentary output

## Wiring the Status LED

The status LED is a low voltage type and must be wired to the Code Encryptor 3. If you attempt to connect it any other way, the LED will burn out and will NOT operate again.

### Status LED Indications

LED Action	Indication
Red LED Flashing	Away mode
Red LED Solid	Stay mode
Green LED Flashing	Not Ready
Green LED Solid	Ready
Yellow LED Flashing Rapidly	Alarm occurred

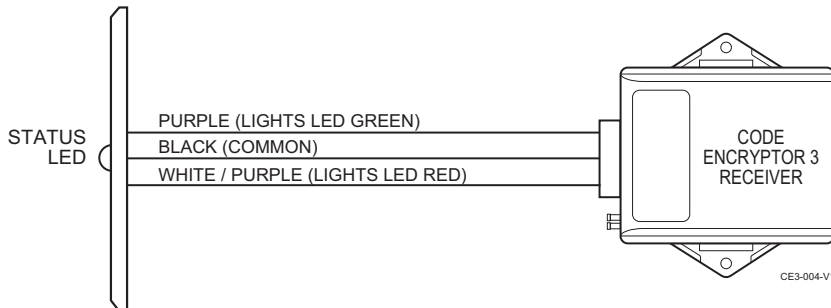

## Wiring to a Garage Door Opener (Channel 3 Application)

When button 3 is pressed, it activates a momentary contact closure for opening and closing a garage door. Occasionally, you may want to use Channel 3 for control of other optional accessories (i.e., garage door motor, Malibu lighting, sprinklers, X-10 automation).

All garage doors have a wall mounted push button that activates the door via a two-wire connection. Make your connection at the push button switch or at the garage door motor where these two wires terminate. Connect the red/white and white wires from the CE3 to these two wires as shown. If you choose to connect to the motor, trace the wires from the push button to the motor and determine the proper connection point. Most garage doors (except MOM Crusader models) use terminals #1 and #2. For MOM Crusader models, use terminals #2 and #3.

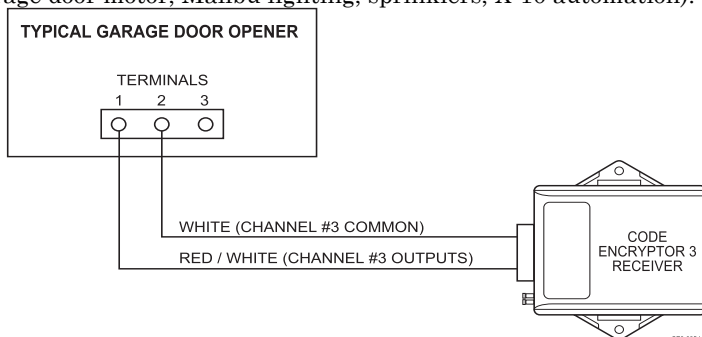

## Channel 4 Applications

When Button 4 is pressed, it activates a 5A Form C relay (Common, N/O, N/C). You can use this output trigger for a 2nd garage door motor, or any device controlled by a momentary relay output.

### Default Mode

When the Code Encryptor 3 is not connected to the data bus of a control panel, it acts as a 2-relay module.

Button 1 triggers Channel 3 - Relay 1 (momentary).

Button 2 triggers Channel 4 - Relay 2 (momentary).

### Channel 1 Momentary (-) Output (Optional)

When you momentarily press button 1 on the Code Encryptor 3 remote, the Gray wire momentarily sends a 500ma (-) output. You can use this output to trigger an exit/entry zone to ensure the panel goes into Away mode.

## PANIC MODE

Press and hold buttons 1 and 2 on the remote control for police panic. This will cause the panel to go into a panic mode. Cancel Panic at a keypad. **THE REMOTE WILL NOT CANCEL A PANIC.**

### Activating panic mode

**NOTE:** This is the default setting of the Code Encryptor 3.

If you have previously programmed remote panic "OFF" and would like to turn it back "ON" follow the steps below. If this is a new installation, Panic "ON" is the DEFAULT setting for the Code Encryptor 3.

1. Unplug the wire harness from the Code Encryptor 3.
2. Press and HOLD the program button.
3. While HOLDING the program button, plug the Code Encryptor 3 harness back in. The LED located on the front will turn ON.
4. Immediately release the program button. Auto recognition will start.

IF NECESSARY, PROGRAM THE ALARM PANEL FOR KEYPAD PANIC.

## Deactivating Panic Mode

In the event the user does not want to access a panic button through the remote control, it can be deactivated from the Code Encryptor 3's memory.

1. Unplug the wire harness from the Code Encryptor 3.
2. Press and HOLD the program button.
3. While HOLDING the program button, plug the CE 3 harness back in. The LED located on the front will turn ON.
4. Wait until the LED turns "OFF".
5. Once the LED has turned "OFF" release the button. Auto recognition will start.

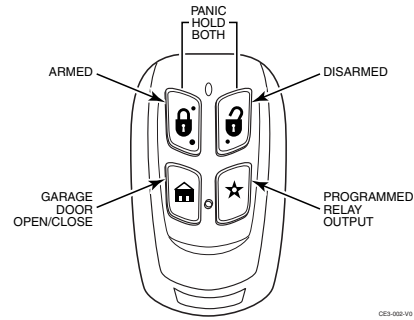

## TEST THE REMOTES

Press and Release button 1 to Arm "Away"

Press and Release button 2 to "Disarm"

Press and Hold button 1 for 3 seconds to Arm "Stay" or "Bypass"

Press and Hold buttons 1 and 2 for two seconds to activate "Panic"

**NOTE:** The Code Encryptor 3 will arm in the AWAY mode even if you are outside the house. We do however recommend that you Arm the alarm system within sight of the status LED or keypad to verify that the system has received and responded to your remote request.

## TROUBLESHOOTING

PROBLEM	SOLUTION
I press Button 1 but nothing happens.	Did you program a <b>valid</b> four-digit user code to the Code Encryptor 3? <b>NOTE:</b> The code you program to the Code Encryptor 3 must be a master code or one of the current user codes. Press button 3. If you do NOT hear a "click" at the receiver, see To Add a New Remote in the Adding/Deleting Remotes section and learn that remote into the Code Encryptor 3.
I press and hold buttons 1 and 2 and I do not get a panic.	Did you program the panel for keypad panic? Program the Code Encryptor 3 for panic. Turn ON Panic (see Panic Mode section)
I am using a DSC 1832 or any Power Series and the alarm will not ARM with the remote.	Make sure you program the Alarm panel for "Quick Key Enable," programming section 015, light #4 is ON. Power down the alarm panel and power it back up. Wait at least 60 seconds before you attempt to use the remote control.
I am using a DSC Power Series and the alarm will not DISARM with the remote.	Enter panel programming. Go to programming section 017. Make sure light #1 is on.
I am using a GE Caddx NX panel and it will only ARM in the STAY mode.	Power down the panel, wait at least 60 seconds and power the panel back up. Reprogram the user code to the CE3 receiver.
Unit does not seem to identify the panel I am using.	Call Technical Support at 800-645-7492.

## SPECIFICATIONS

- Receiver:**
- 12VDC Power Input
  - Channels 1 & 2 Data outputs
  - Channel 3 Relay (N/O, Common) 10amp - momentary
  - Channel 4 selectable: Form C Relay (N/O, N/C, Common) 5amp - momentary
  - Channel 5 (top 2-buttons at same time) - momentary
- Keypad panic data output (Programmable On or OFF)

**Frequency:** 433 MHz

**Stand by Power Consumption:** 13mA on standby (40mA max)

**Temperature Range:** -5°F to 160°F (Indoor use only)

**Remote Control Battery:** 6VDC Mini (2x Part # CR-2025) Replace battery once a year.

**Technical Support:** M-F 9AM-7PM EST (800) 645-7492; **Sales:** (858) 513-1224

### Federal Communications Commission (FCC) Part 15 Statements

The user shall not make any changes or modifications to the equipment unless authorized by the Installation Instructions or User's Manual. Unauthorized changes or modifications could void the user's authority to operate the equipment.

### CLASS B DIGITAL DEVICE STATEMENT

This equipment has been tested to FCC requirements and has been found acceptable for use. The FCC requires the following statement for your information: This equipment generates and uses radio frequency energy and if not installed and used properly, that is, in strict accordance with the manufacturer's instructions, may cause interference to radio and television reception. It has been type tested and found to comply with the limits for a Class B computing device in accordance with the specifications in Part 15 of FCC Rules, which are designed to provide reasonable protection against such interference in a residential installation. However, there is no guarantee that interference will not occur in a particular installation. If this equipment does cause interference to radio or television reception, which can be determined by turning the equipment off and on, the user is encouraged to try to correct the interference by one or more of the following measures:

- If using an indoor antenna, have a quality outdoor antenna installed.
- Reorient the receiving antenna until interference is reduced or eliminated.
- Move the radio or television receiver away from the receiver/control.
- Move the antenna leads away from any wire runs to the receiver/control.
- Plug the receiver/control into a different outlet so that it and the radio or television receiver are on different branch circuits.
- Consult the dealer or an experienced radio/TV technician for help.

### INDUSTRY CANADA (IC) STATEMENTS

This device complies with RSS210 of Industry Canada. Operation is subject to the following two conditions: (1) This device may not cause harmful interference, and (2) This device must accept any interference received, including interference that may cause undesired operation.

Cet appareil est conforme à la partie 15 des règles de la FCC & de RSS 210 des Industries Canada. Son fonctionnement est soumis aux conditions suivantes: (1) Cet appareil ne doit pas causer d'interférences nuisibles. (2) Cet appareil doit accepter toute interférence reçue y compris les interférences causant une réception indésirable.

This Class B digital apparatus complies with Canadian ICES-003.

Cet appareil numérique de la classe B est conforme à la norme NMB-003 du Canada.

### WARRANTY INFORMATION

For the latest warranty information, please go to:  
[www.honeywell.com/security/hsc/resources/wa](http://www.honeywell.com/security/hsc/resources/wa)



800-04965 8/09 Rev. C

**Honeywell**

2 Corporate Center Drive, Suite 100  
P.O. Box 9040, Melville, NY 11747

Copyright © 2009 Honeywell International Inc.  
[www.honeywell.com/security](http://www.honeywell.com/security)